

1311A-1A

FIGURE 158. WHEEL ASSEMBLY AND CTIS VALVE (SHEET 1 OF 2)

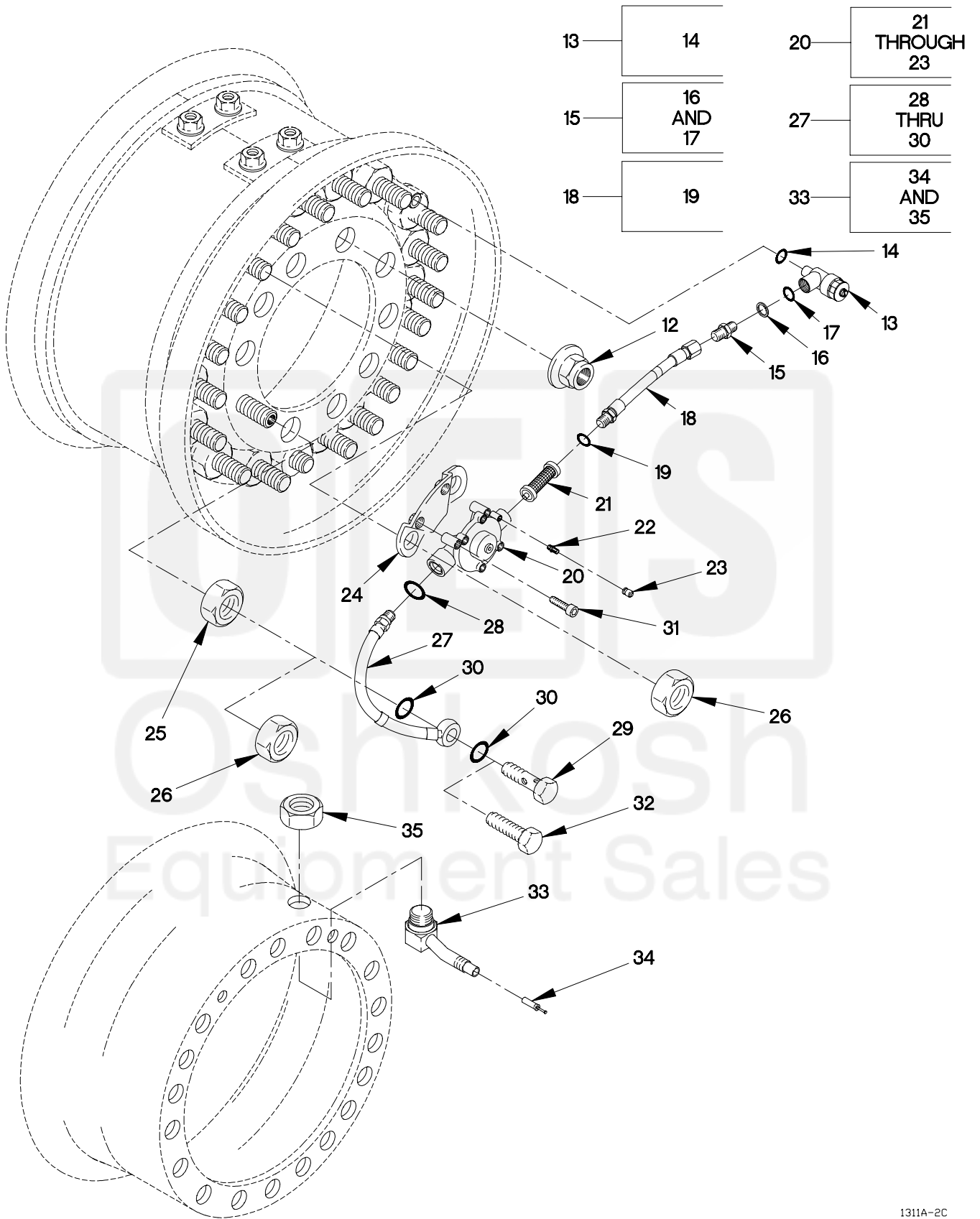

1311A-2C

FIGURE 158. WHEEL ASSEMBLY AND CTIS VALVE (SHEET 2 OF 2)

SECTION II

TM 9-2320-365-24P

| (1) ITEM NO | (2) SMR CODE | (3) CAGEC CAGEC | (4) PART NUMBER | (5) DESCRIPTION AND USABLE ON CODE (UOC) | (6) QTY |
|--|--------------------|-----------------------|-----------------------|---|------------|
| GROUP 1311: WHEEL ASSEMBLY FIG.158 WHEEL ASSEMBLY AND CTIS VALVE | | | | | |
| 1 | AOOOF | 20076 | 05-10058-00 | WHEEL,PNEUMATIC TIR..... | 1 |
| 2 | PAOOF | 20076 | 05-10110-00 | .WHEEL,PNEUMATIC TIR..... | 1 |
| 3 | PAOZZ | 0FW39 | 12417332-001 | ..BOLT,ECCENTRIC HEAD 5/8-18 X 2 7/16..... | 18 |
| 4 | PAOZZ | 19207 | 12417332-002 | ..BOLT,ECCENTRIC HEAD 5/8-18 X 1 9/16..... | 2 |
| 5 | PAOZZ | 20076 | OR420A | .O-RING..... | 1 |
| 6 | PAOZZ | 20076 | 05-10107-00 | .WHEEL SEGMENT,PNEUM..... | 1 |
| 7 | PAOZZ | 19207 | 12301125 | .NUT,SELF-LOCKING,EX..... | 20 |
| 8 | PAOOO | 62161 | T 1001 | BEADLOCK,PNEUMATIC..... | 1 |
| 9 | PAOZZ | 96906 | MS90727-58 | .SCREW,CAP,HEXAGON H 3/8-24 X 3/4.. | 4 |
| 10 | PAOZZ | 19207 | 12414420-002 | .PLATE,MENDING..... | 2 |
| 11 | PAOZZ | 19207 | 12414420-004 | .NUT,SELF-LOCKING,HE..... | 4 |
| 12 | PAOZZ | 19207 | 10938443-1 | NUT,PLAIN,SINGLE BA 3/4-16 (ROAD SIDE)..... | 18 |
| 12 | PAOZZ | 19207 | 10938443-2 | NUT,PLAIN,SINGLE BA 3/4-16 (CURB SIDE)..... | 18 |
| 13 | PAOZZ | 1MVZ1 | 673245 | VALVE,ANGLE KNEELING,10PSI..... | 1 |
| 13 | PAOZZ | 19207 | 12417916 | ELBOW,TUBE TO HOSE (SPARE AND REAR TIRES ONLY)..... | 1 |
| 14 | PAOZZ | 1MVZ1 | 5999807 | .SEAL,NONMETALLIC RO..... | 1 |
| 15 | PAOZZ | 1MVZ1 | 673994 | ADAPTER,STRAIGHT,TU (FRONT)..... | 1 |
| 15 | PAOZZ | 1MVZ1 | 673995 | ADAPTER,STRAIGHT,TU (REAR)..... | 1 |
| 16 | PAOZZ | 1MVZ1 | 673996 | .WASHER,SEAL USE ON P/N 673994..... | 1 |
| 17 | PAOZZ | 1MVZ1 | 673268 | .SEAL,NONMETALLIC RO USE ON P/N 673994 AND 673995..... | 1 |
| 18 | PAOZZ | 1MVZ1 | 676200 | HOSE ASSY,NONMETAL..... | 1 |
| 19 | PAOZZ | 1MVZ1 | 673268 | .SEAL,NONMETALLIC RO..... | 1 |
| 20 | PAOZZ | 1MVZ1 | 673217 | VALVE,PNEUMATIC..... | 1 |
| 21 | PAOZZ | 1MVZ1 | 599791 | .FILTER ELEMENT,FLUI..... | 1 |
| 22 | PAOZZ | 1MVZ1 | 673215 | .VALVE,TANK..... | 1 |
| 23 | PAOZZ | 81381 | 673719 | .CAP..... | 1 |
| 24 | PAOZZ | 1MVZ1 | 673222 | BRACKET,MOUNTING..... | 1 |
| 25 | PAOZZ | 19207 | 10938444-1 | NUT,PLAIN,SINGLE BA 1 1/8-16 LEFT HAND..... | 2 |
| 25 | PAOZZ | 19207 | 10938444-2 | NUT,PLAIN,SINGLE BA 1 1/8-16 RIGHT HAND..... | 2 |
| 26 | PAOZZ | 96906 | MS35691-53 | NUT,PLAIN,HEXAGON 5/8-UNF (FOR SPARE TIRE)..... | 1 |
| 27 | PAOZZ | 1MVZ1 | 673997 | HOSE ASSEMBLY,NONME..... | 1 |

SECTION II

TM 9-2320-365-24P

| (1) ITEM NO | (2) SMR CODE | (3) CAGEC | (4) PART NUMBER | (5) DESCRIPTION AND USABLE ON CODE (UOC) | (6) QTY |
|-------------------|--------------------|--------------|-----------------------|--|------------|
| 28 | PAOZZ | 1MVZ1 | 673269 | .O-RING..... | 1 |
| 29 | PAOZZ | 1MVZ1 | 673998 | .BOLT,FLUID PASSAGE..... | 1 |
| 30 | PAOZZ | 1MVZ1 | 673999 | .SEAL,NONMETALLIC RO..... | 2 |
| 31 | PAOZZ | 19207 | 12414475-224 | SCREW,CAP,SOCKET HE M8 X 1.25 X 30. | 2 |
| 32 | PAOZZ | 80204 | B1821BH063F150N | SCREW,CAP,HEXAGON H 5/8-18 X 1 1/2 (SPARE TIRE ONLY)..... | 1 |
| 33 | PAOZZ | 17875 | VS-1090-ALT | VALVE,PNEUMATIC TIR..... | 1 |
| 34 | PAOZZ | 81348 | TYV/CL2/TR C1 | .VALVE CORE..... | 1 |
| 35 | PAOZZ | 17875 | 265 | .NUT,PLAIN,HEXAGON 11/16-16..... | 1 |

END OF FIGURE

